

BOARD OF PUBLIC WORKS AND SAFETY
Agenda Request Form

(Form B-01-2012)

Organizations and individuals are asked to submit a request form and supporting documents to be placed on the agenda. You will be contacted by the City confirming the date of the meeting in which your request will be heard.

Please make sure that your contact information is accurate in case we need to get in touch with you. The Board of Works meets on the 1st and 3rd Monday of each month at 5:00 p.m. in City Hall located at 70 E. Monroe Street.

Date Submitted:	3-28-14	Requested Meeting Date:	4-7-14
		Confirmed Meeting Date:	
Received by:			
Contact Information: Please provide all requested information in the fields below. (Print or Type)			
On Behalf of Organization or Individual:		Planning and Engineering Department	
Name:	Travis Underhill	Telephone:	736-3631
Title or Position:	City Engineer		
E-Mail:	tunderhill@franklin.in.gov		
Address:	70 E. Monroe Street		
City:	Franklin	State:	IN
ZIP:	46131		
Who will attend the meeting and present the request?			
Name:	David Lach	Telephone:	317-706-6361
Title or Position:	Representative for Cripe Architects and Engineers		
E-Mail:	dlach@cripe.biz		
Please describe the purpose or title of your presentation.			
Request permission to demo and rebuild in sanitary easement.			
Supporting documents: All supporting documents should be submitted with the request form.			
1. Letter			
2. Site Exhibits			
3.			
4.			



Architects + Engineers

Solutions by Design Since 1937

Telephone 317.844.6777

3939 Priority Way South Drive, Suite 400
Indianapolis, Indiana 46240
www.cripe.biz

Facsimile 317.706.6451

March 26, 2014

Mayor Joe McGuinness, Chairman
Board of Public Works
70 E. Monroe St.
Post Office Box 280
Franklin, IN 46131

RE: Indiana Masonic Home Amenities Building

Dear Mayor McGuinness and Members of the Board:

As a representative on behalf of the Indiana Masonic Home, Cripe Architects + Engineers respectfully requests to be heard at the April 8, 2014 Board of Public Works meeting for consideration and approval of a proposed amenities building and its proposed location relative to an existing sanitary sewer that will be reconstructed in place.

Please contact me at 317-706-6361 or dlach@cripe.biz if you have any questions or need any additional information.

Sincerely,

CRIFE ARCHITECTS + ENGINEERS

David A. Lach, PE, LEED AP, BD +C
Director, Site Services

Cc: Jerry Loper, Indiana Masonic Home
Joanna Myers, Senior Planner, City of Franklin
Travis Underhill, City Engineer, City of Franklin

	ST	ST	STORM SEWER, MANHOLE		END SECTION
---	---	---	SUBSURFACE DRAIN (SSD)		CURB INLET
	RD	RD	ROOF DRAIN, CLEANOUT		SEWER INLETS
	W	W	WATER LINE, METER, VALVE		"TEE" FITTING
	SS	SS	SANITARY SEWER, MANHOLE		TAPPING SLEEVE & VALVE
	SS	SS	SANITARY LATERAL, CLEAN OUT		FIRE HYDRANT
---	---	---	EASEMENT LINE		FIRE DEPARTMENT CONNECTION
	E	E	OVERHEAD ELECTRIC, POLE		POST INDICATOR VALVE
	BEC	BEC	BURIED ELECTRIC, MANHOLE		STREET LIGHT
---	CTV	CTV	OVERHEAD CABLE TELEVISION		TRANSFORMER
---	BCTV	BCTV	BURIED CABLE TELEVISION		ELECTRIC METER
	G	G	GAS LINE, METER, VALVE		CABLE RISER PEDESTAL
---	T	T	OVERHEAD TELEPHONE LINE		
---	BTC	BTC	BURIED TELEPHONE LINE		

[illegible]

- ARCHITECTURE
- EQUIPMENT PLANNING
- INTERIOR DESIGN
- CIVIL / TRANSPORTATION ENGINEERS
- LAND PLANNING
- LAND SURVEYING
- GIS
- OWNER'S REPRESENTATION

RITY WAY SOUTH DRIVE, SUITE 400
IANAPOLIS, INDIANA 46240
844-6777 FAX (317) 706-6464
E-Mail crpe@cripe.biz



OVERALL SITE PLAN EXHIBIT _____

INDIANA MASONIC HOME AMENITIES BUILDING

project / Developer

Project Address 01
Project Address 02

Project Address 02

CERTIFIED BY:

Date 00-00-00

COVERING
OVERALL SITE PLANNING
DESIGN



811 1-800-382-5544
FOR CALLS IN INDIANA CALL TOLL FREE

Checked By:	
-------------	--

Quality Assurance:

Scale: 0

Sheet **EXHIBIT**

Date	03-27-14
------	----------

Project Number
090364-20000

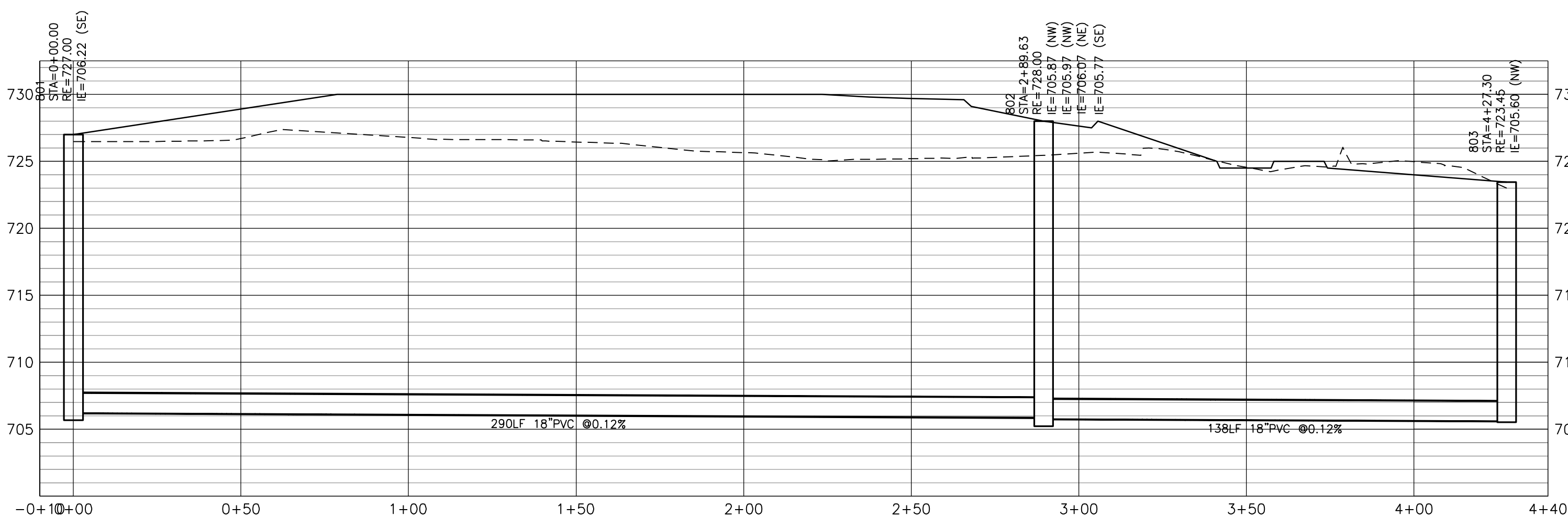

C:\Masonic Home\CDs\C801_Sanitary Plan and Profile.dwg , March 27, 2014 1:21 PM, JUSTIN OLASHUK, © Paul I. Cripe, Inc.

The diagram shows a cross-section of a road project. The vertical axis represents elevation in feet, with labels at 800, 805, and 800. The horizontal axis is labeled 'STATION' with a specific point marked as '2+00'. A solid line represents the 'PROPOSED GRADE', which slopes downward from left to right. A dashed line represents the 'EXISTING GROUND', which is relatively flat. The area between the proposed grade and the existing ground is labeled 'GRANULAR BACKFILL'. The existing ground is shown to be below the proposed grade throughout the section.

© Paul I. Cripe, Inc.